

MULTI-VOLT MICRO-TOUCH PUSHBUTTON CUTOUTS AND STUD PATTERNS

PB1, PB2, PB3, PB11, PB12, PB13, PB14,
PB15, PB19, PB20, PB21, PB29, PB30,

PB31, PB33

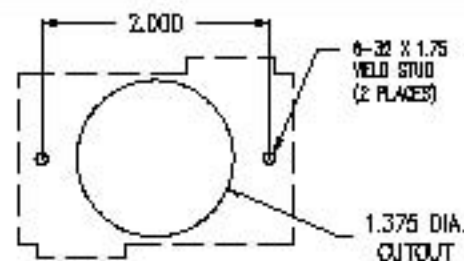

PB4, PB5, PB6, PB22, PB32, PB34

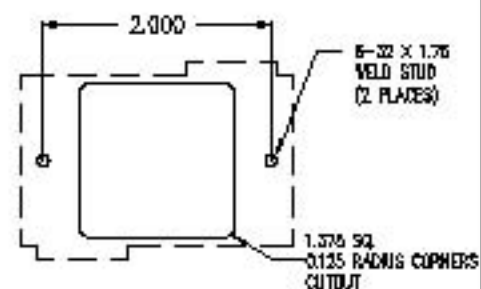

PB16, PB17, PB18

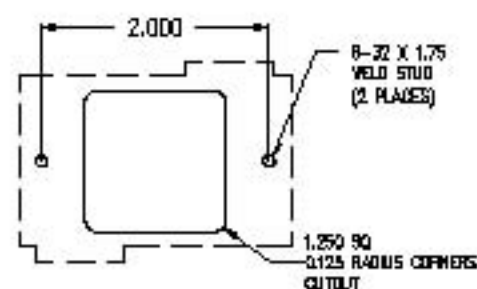

PB23, PB24, PB25, PB26, PB27, PB28

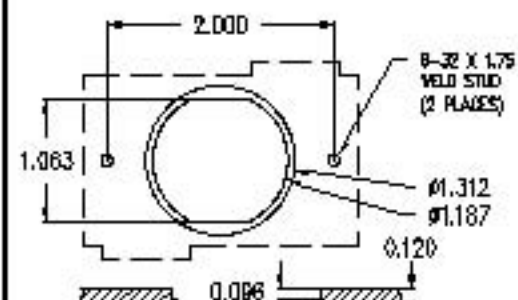

PB7, PB8

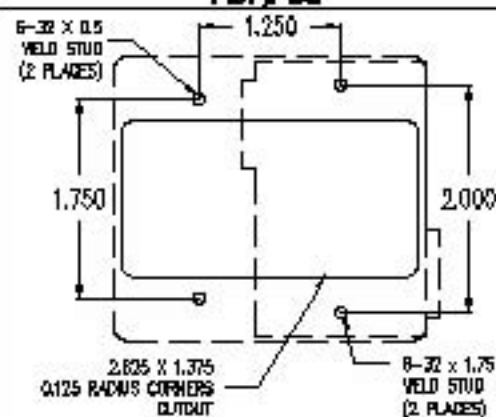

PB10

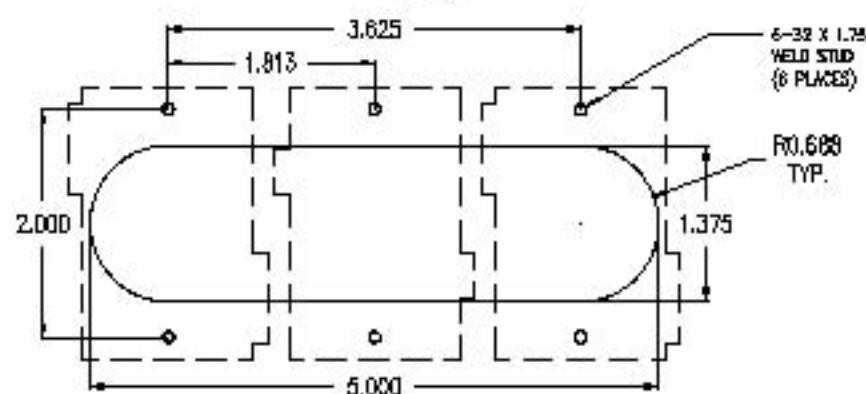

TYPICAL SIDE VIEW

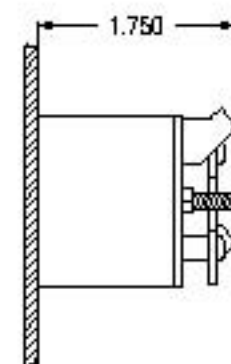

NOTE:

PB7, PB8, AND PB10 MOUNTING IS ONLY AS SHOWN.

ALL OTHER STUD PATTERNS CAN BE ROTATED 90° FOR VERTICAL MOUNTING.

**INNOVATION
INDUSTRIES INC**

P.O. BOX 8888
RUSSELLVILLE, AR 72811
U.S.A.